

PANEL MOUNTING

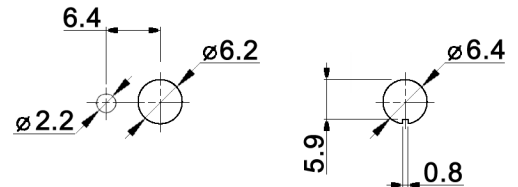

CONTACT ARRANGEMENT

code for x	function	toggle towards keyway	toggle opposite to keyway
N	On-On	1-2, 4-5	2-3, 5-6
R	Mom-On	1-2, 4-5	2-3, 5-6

code for x	function	toggle towards keyway	toggle in center	toggle opposite to keyway
P	On-Off-On	1-2, 4-5	open	2-3, 5-6
S	Mom-Off-Mom			
T	Mom-Off-On			
PA	On-On-On	1-2, 4-5	1-2, 5-6	2-3, 5-6
SA	Mom-On-Mom			
TA	Mom-On-On			

Specifications:

- Contact rating: 3A, 250V AC / 6A, 125V AC
4A, 30V DC / 5A, 12V DC
6A, 6V DC
- Contact resistance: 20mOhm max.
- Insulation resistance: 1 000MOhm min. at 500V DC
- Dielectric strength: 1 500V, 50Hz for the duration of 1 minute
- Operating temperature: -45°C to +140°C
- Mechanical life: min. 200 000 cycles (SA, TA: 100 000 cycles)
- Soldering conditions: hand-soldering: max.: 420°C, 3sec., 60W
auto-soldering: max.: 270°C, 5sec.
- Mounting instruction: max. torque: 49Ncm
- Material: Contact portion: solid silver
Other conducting parts: brass, 10µm silver plated over 1.5µm nickel
Housing: stainless steel, CNS9265
Bushing: copper alloy, C3604BD nickel plated
Actuator: copper alloy, C3604BD chrome plated
- Included accessories: 2 pcs. nut M6x0.75, nickel plated, 9mm wrench size
1 pc. tooth washer
1 pc. locking washer

Compliance: RohS III (2015/863/EU)

Tolerances: 0.00: ±0.25mm 0.0: ±0.40mm	Date	Name	<h1>MTA 206 x</h1>
	04/09	dr	
Function table	10/19	dr	<h1>30 17 88</h1>
Material	07/11	dr	
Dimension	01/11	dr	
Panel mounting	05/10	dr	
Modifications	Date	Name	
knitter-switch			Page 1/1